

# SQTV11 Series Dual Axis joystick

## Product Features

SQTV11 Industrial Joystick is mainly is used in various secondary circuits with AC 50Hz(60Hz),rated voltage of 380V(440V) and below, and can realize motor commutation, speed regulation, braking, linkage, transfer,etc,Can also be mounted on the console surface or portable control box.

## Application

SQTV11 IS widely used in all kinds of mechanical equipment in port,shipping,railway,metallurgy, mining,power, construction,manufacturing.



## Technical Information

Operating temperature	-40℃ ~ +85℃
Operating torque	≤20N
Maximum operating direction	8
The number of mechanisms can be controlled	2
Maximum number of gears	4
Installation of flange protection grade	IP54
Potentiometer can be added to each master	2
Nominal voltage	380V/440
Rated current	10A
Mechanical life	5,000,000 cycle

## Product configuration

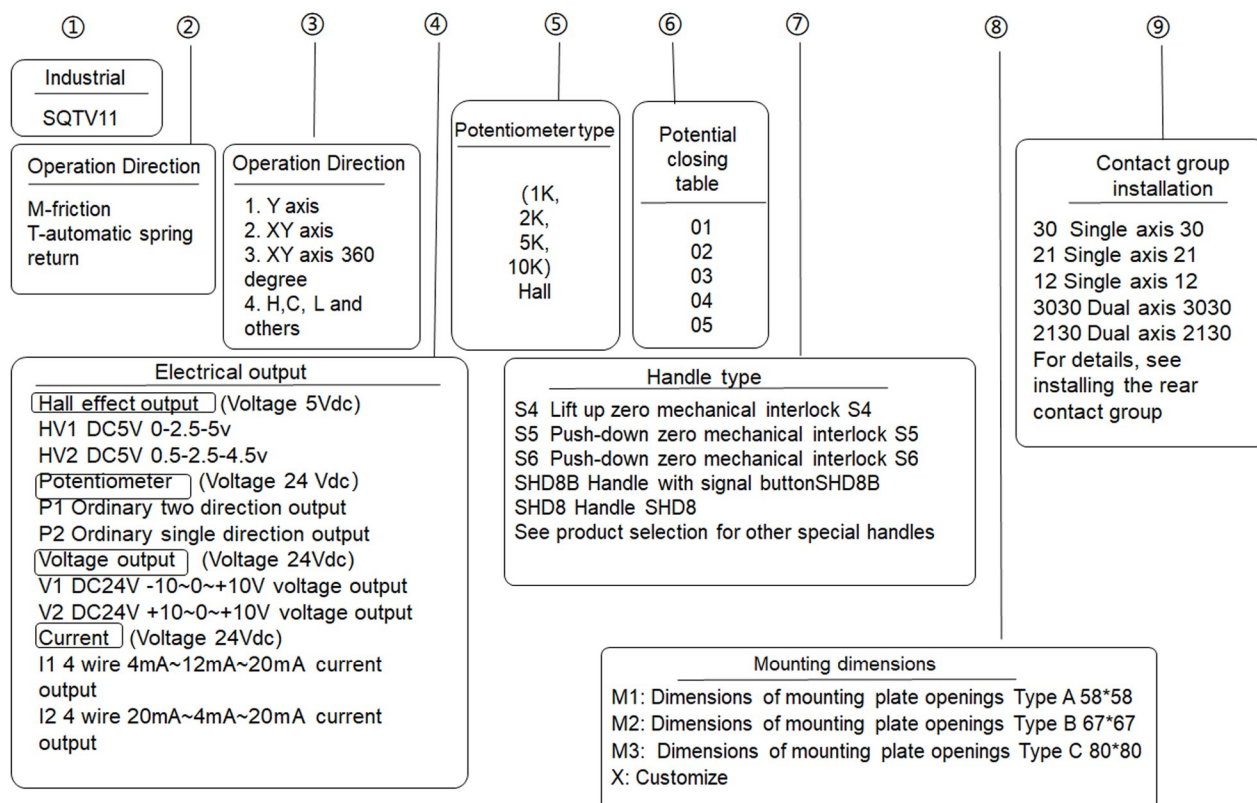

## Product Size

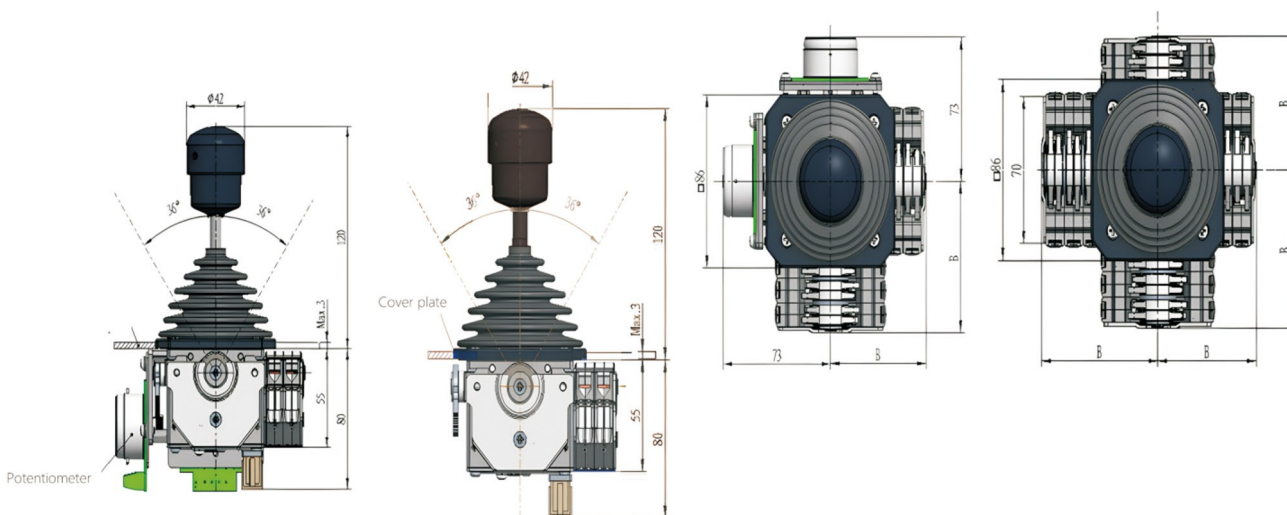

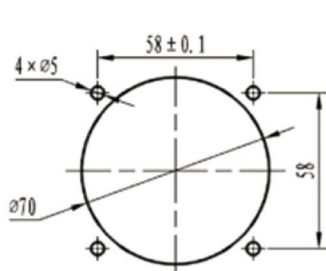

M1

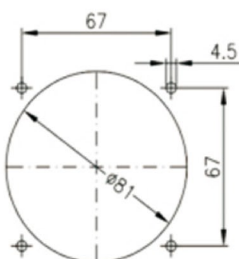

M2

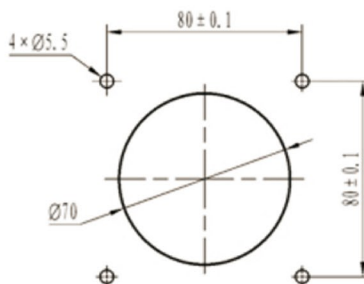

M3

×

Type	Contact number	Size B
01	2	51
02	4	64
03	6	76

## Base unit

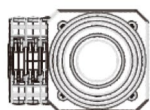

Single axis 30

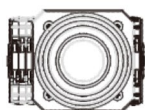

Single axis 21

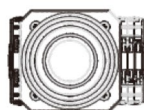

Single axis 12

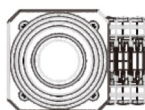

Single axis 03

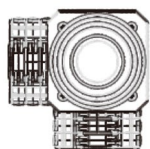

Dual axis 3030

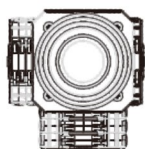

Dual axis 2130



Dual axis 2121



Dual axis 1221

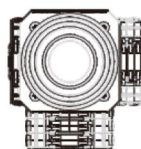

Dual axis 1230

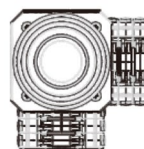

Dual axis 0330

## Potential closing table

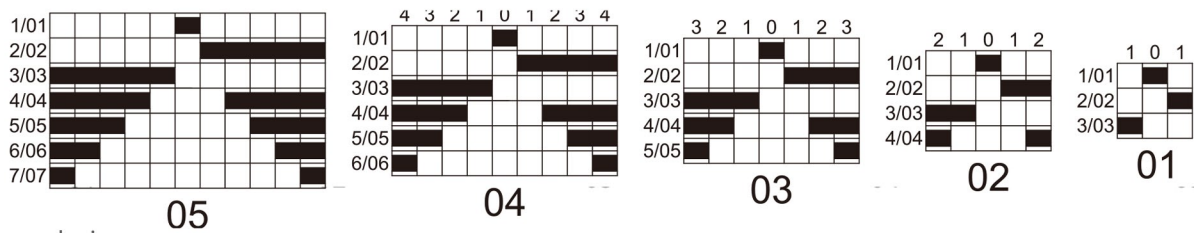

## Hand type

